

# Region of Peel 18-1310C – Dundas St East Watermain Replacement



Dundas Street East Follow Up Discussion  
Ward 1 - Councillor Dasko  
Ward 3 - Councillor Fonseca

Updated: March 28, 2025

# Agenda



1. Introductions
2. Assessment of Current Issues
3. Immediate Action items (Update)
4. Long Term Solutions for Traffic Control
5. Current Project Progress

# Current Issues

- Traffic Control
  - More lane closures than necessary
  - Closures are a longer distance than necessary
  - Line painting is inadequate
- Site Tidiness
- Delayed Completion Date

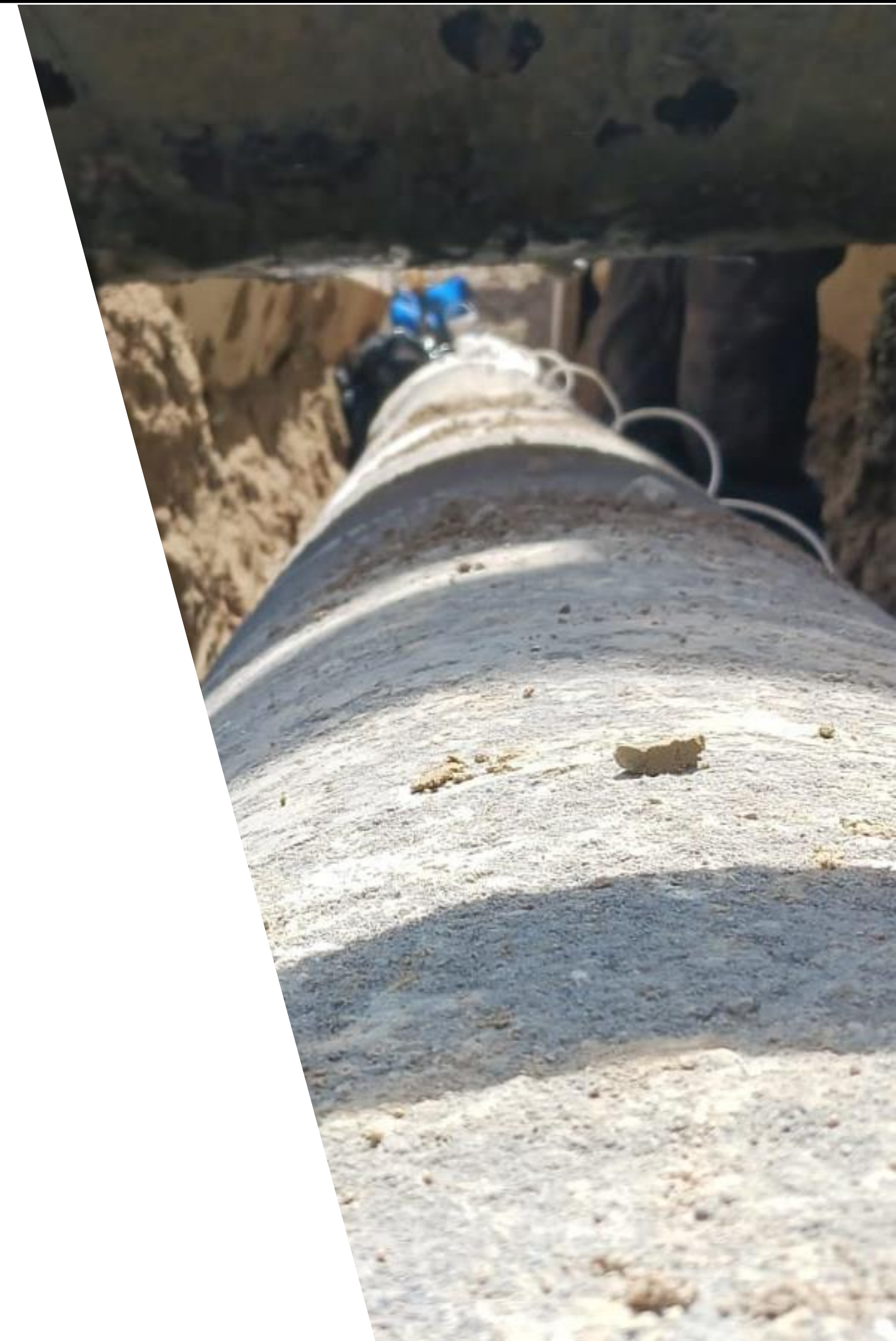

# Immediate Action Items

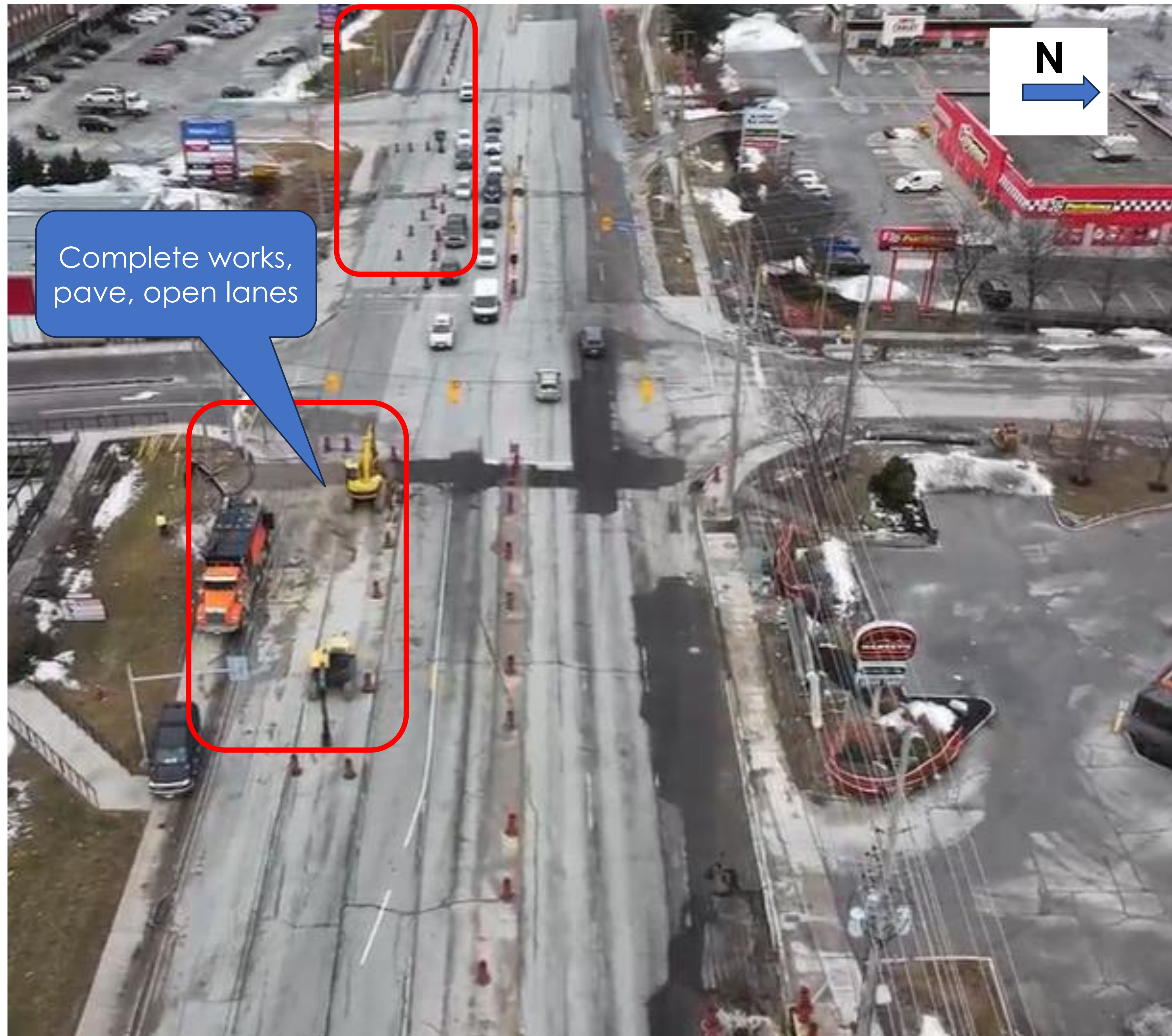

## From Neilco Ct to Dixie – March 7th

- Issue was raised on March 7<sup>th</sup> during meeting with Councillor Fonseca
- Open Eastbound lanes through Dixie to Neilco

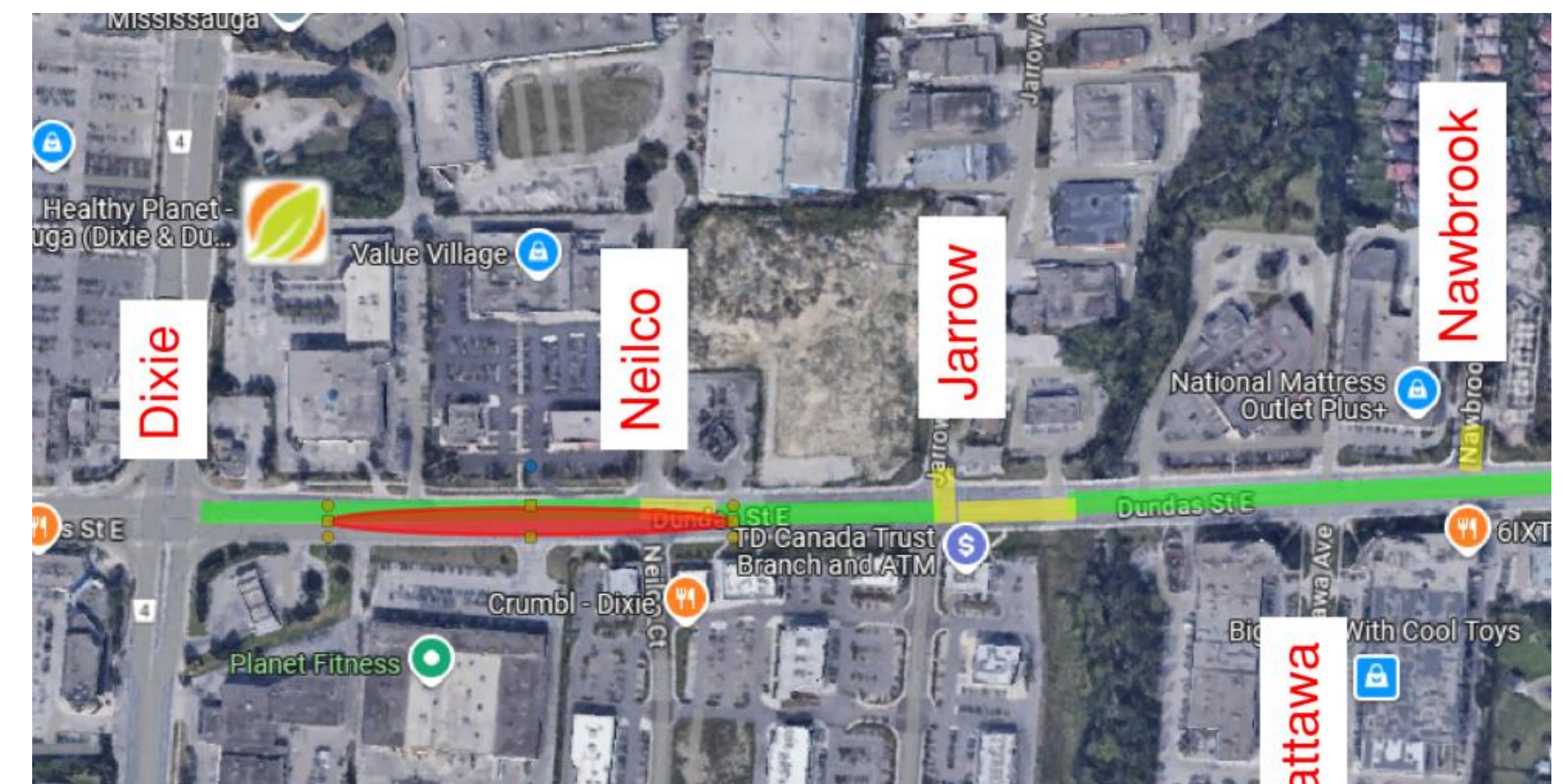

# Immediate Action Items



## From Neilco Ct to Dixie – March 27th

- Work completed, paved and lines repainted.
- Major improvements in traffic moving Eastbound from Dixie

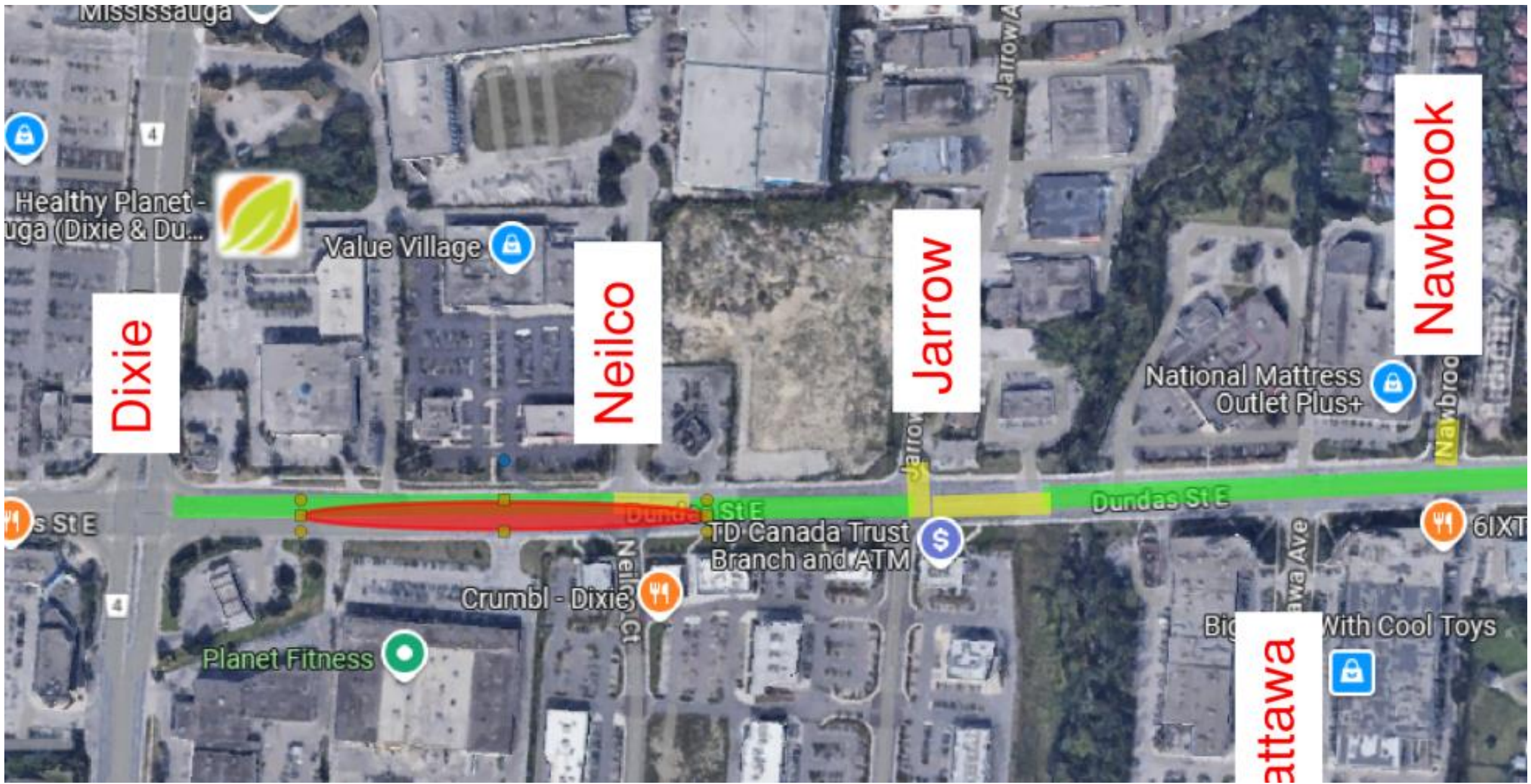

# Immediate Action Items

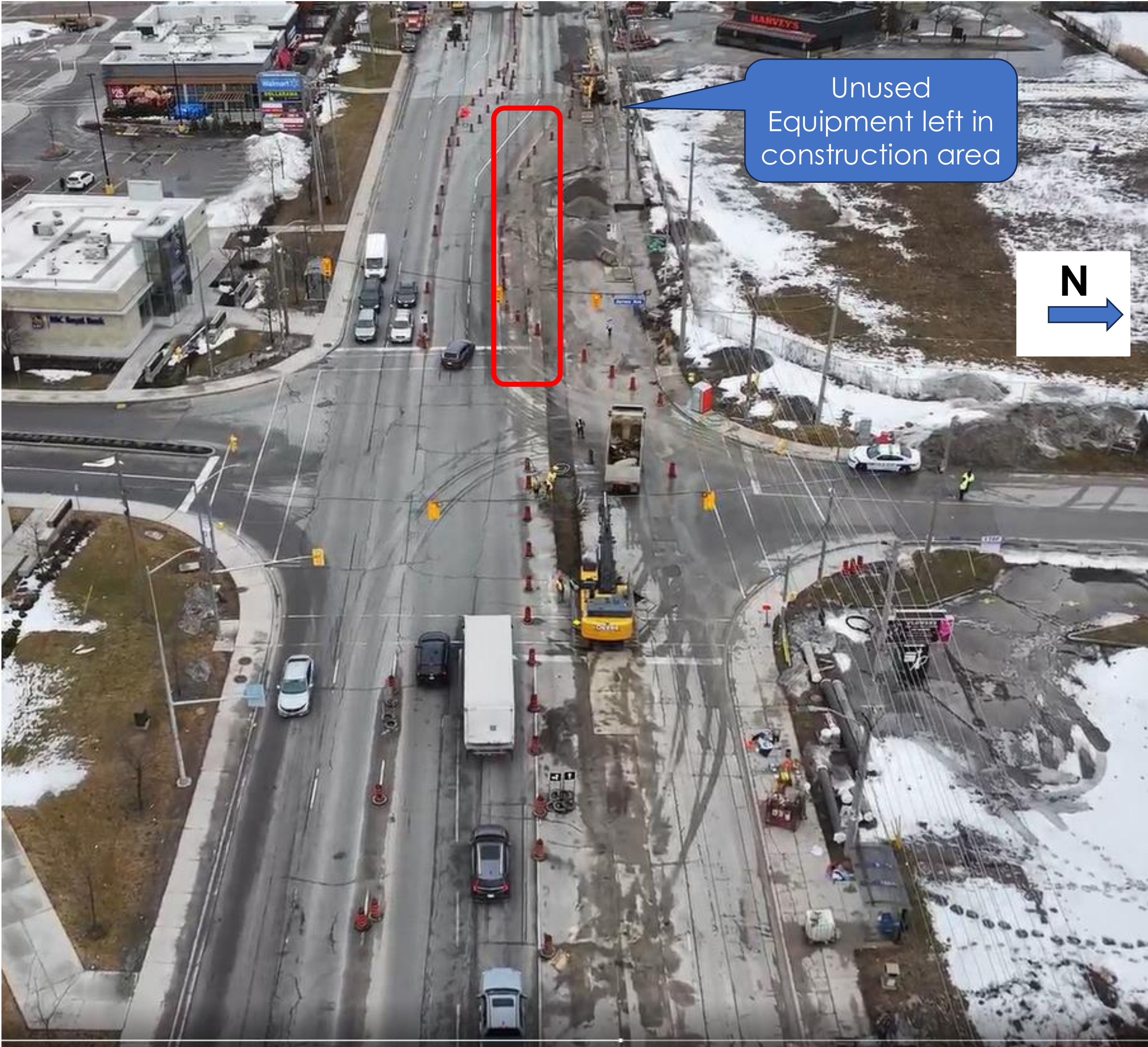

## From Jarrow Ave to Neilco Ct – March 7th

- Open Westbound lane past Jarrow when possible
- Remove unnecessary equipment

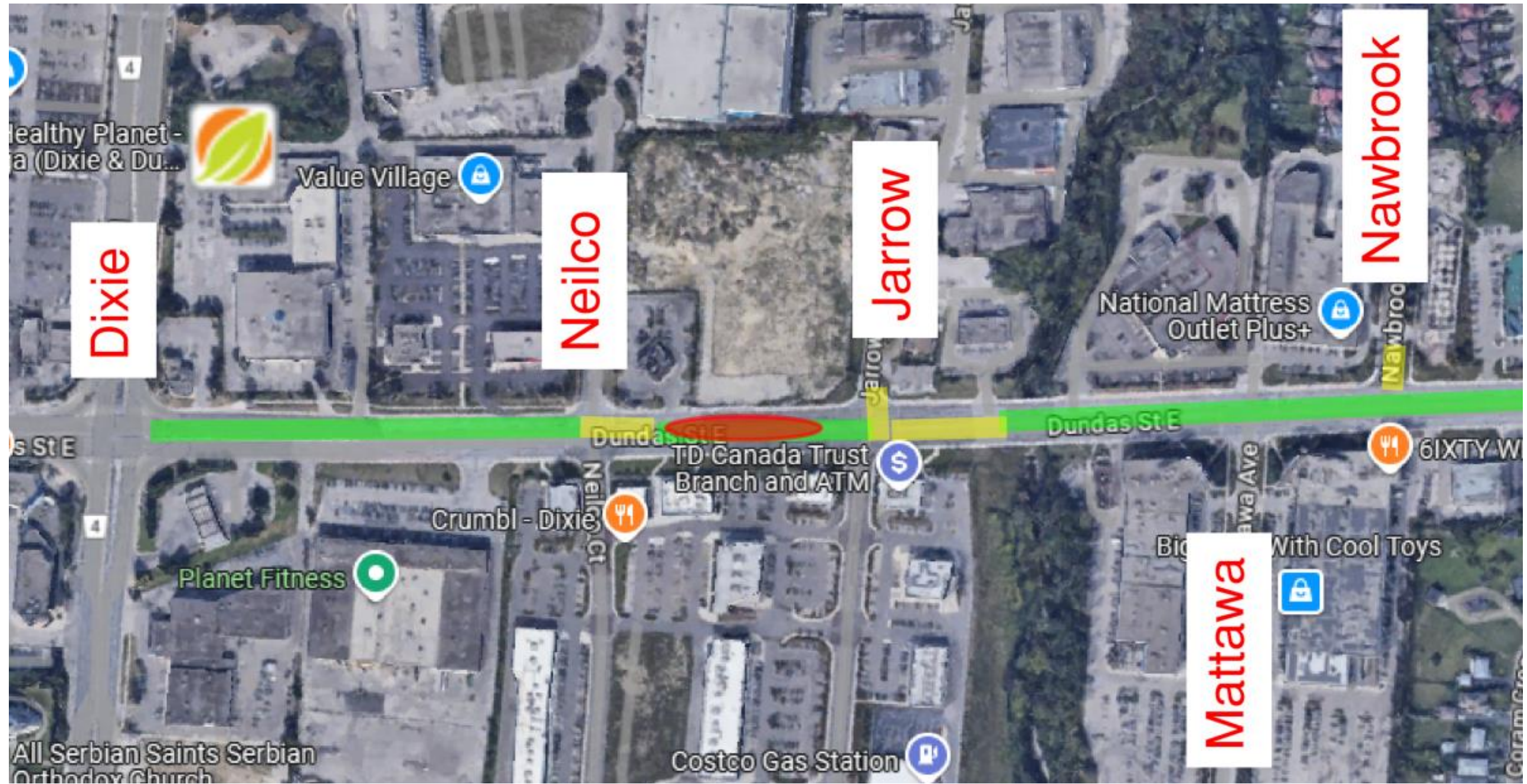

# Immediate Action Items



## From Jarrow Ave to Neilco Ct – March 27th

- Taper length shortened
- Unused equipment has been moved to their compound or to a safer lay down area
- This lane is to be swept and opened for peak traffic hours (before 9am and after 4pm)

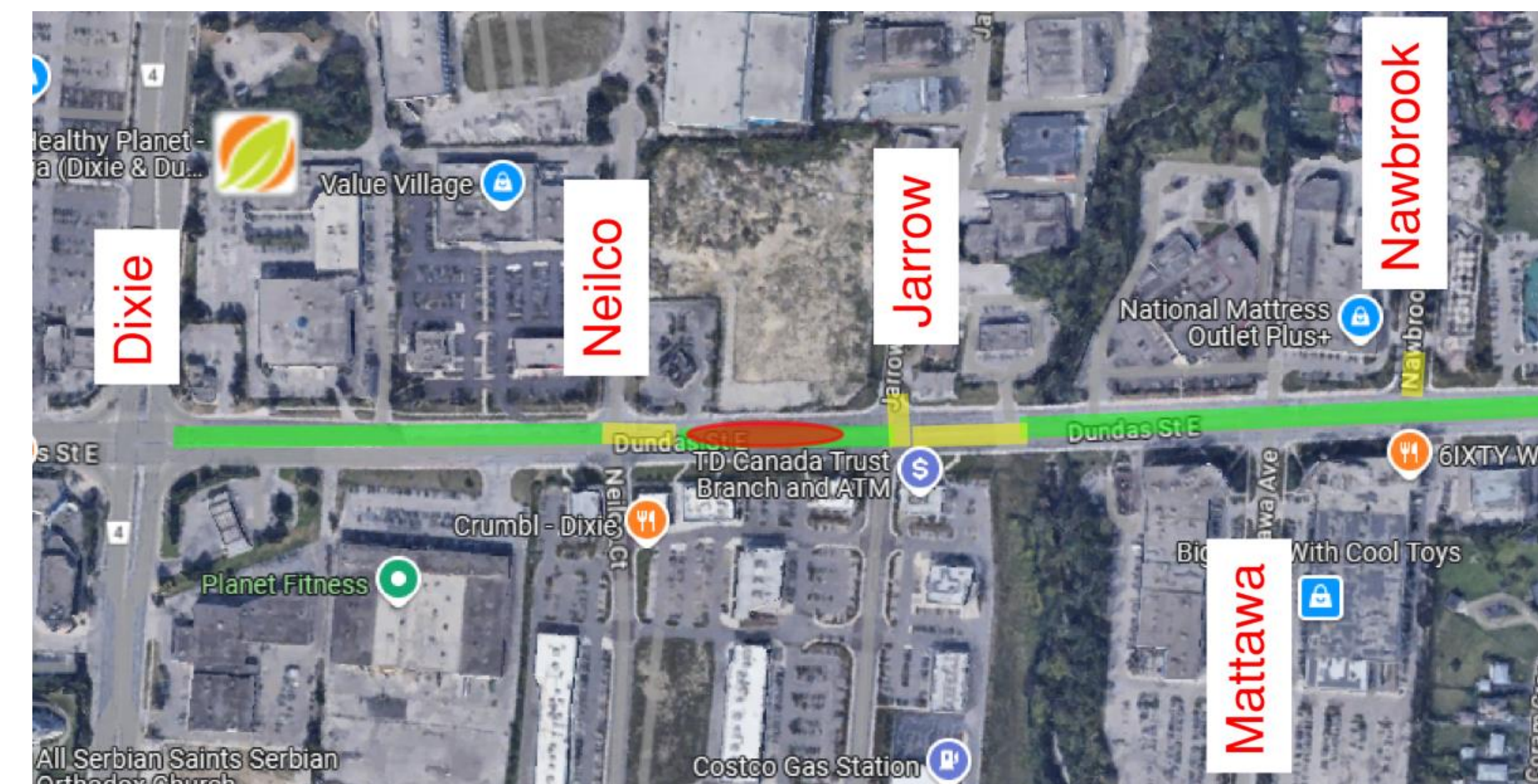

# Immediate Action Items



## From Mattawa Ave to Jarrow Ave – March 7th

- Remove unnecessary equipment from boulevards
- Tidy closed lanes
- Sweep newly opened lanes

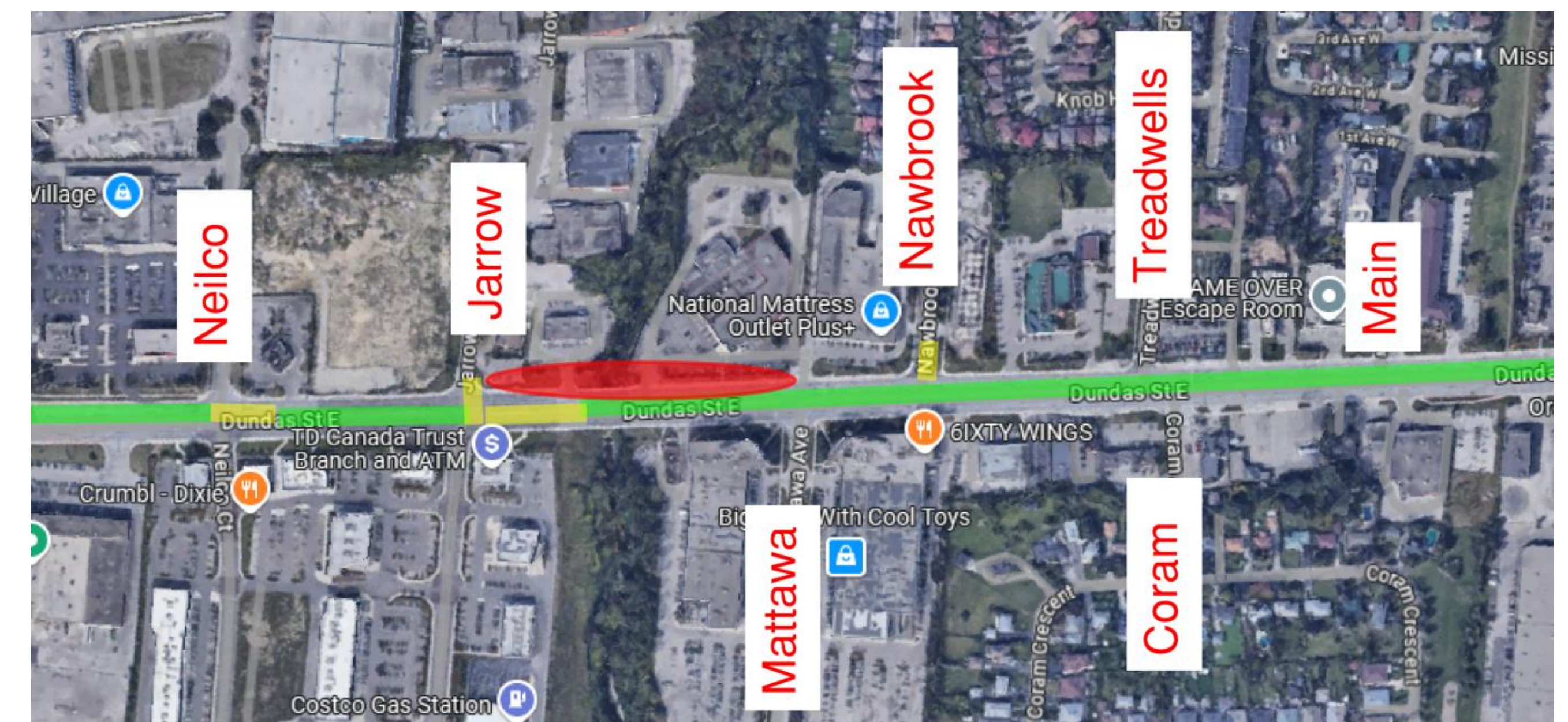

# Immediate Action Items



## From Mattawa Ave to Jarrow Ave – March 27th

- Worked with adjacent tunneling project team to cleanup unused equipment
- The tunneling project is using these closed lanes with an emphasis on keeping them tight to the operation

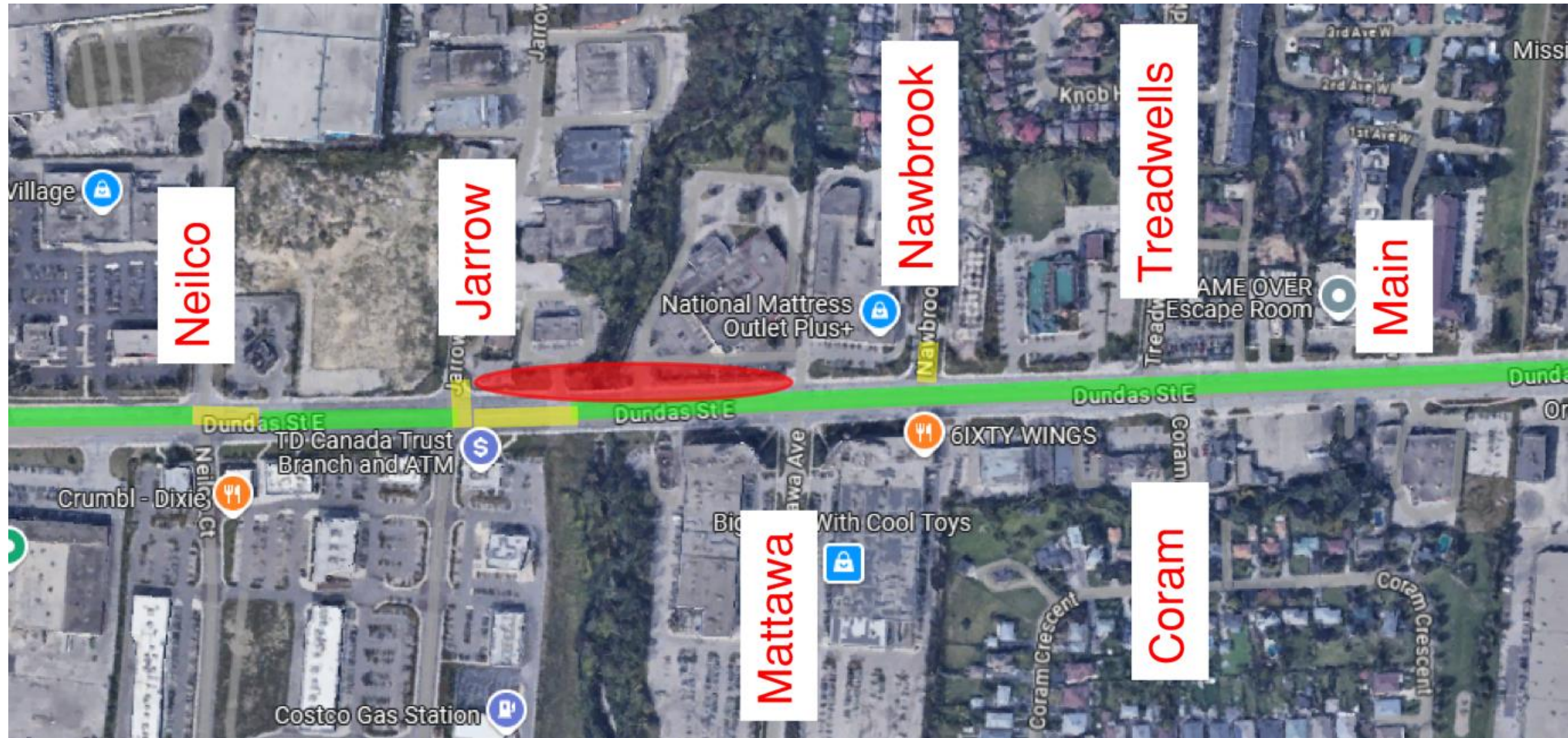

# Immediate Action Items

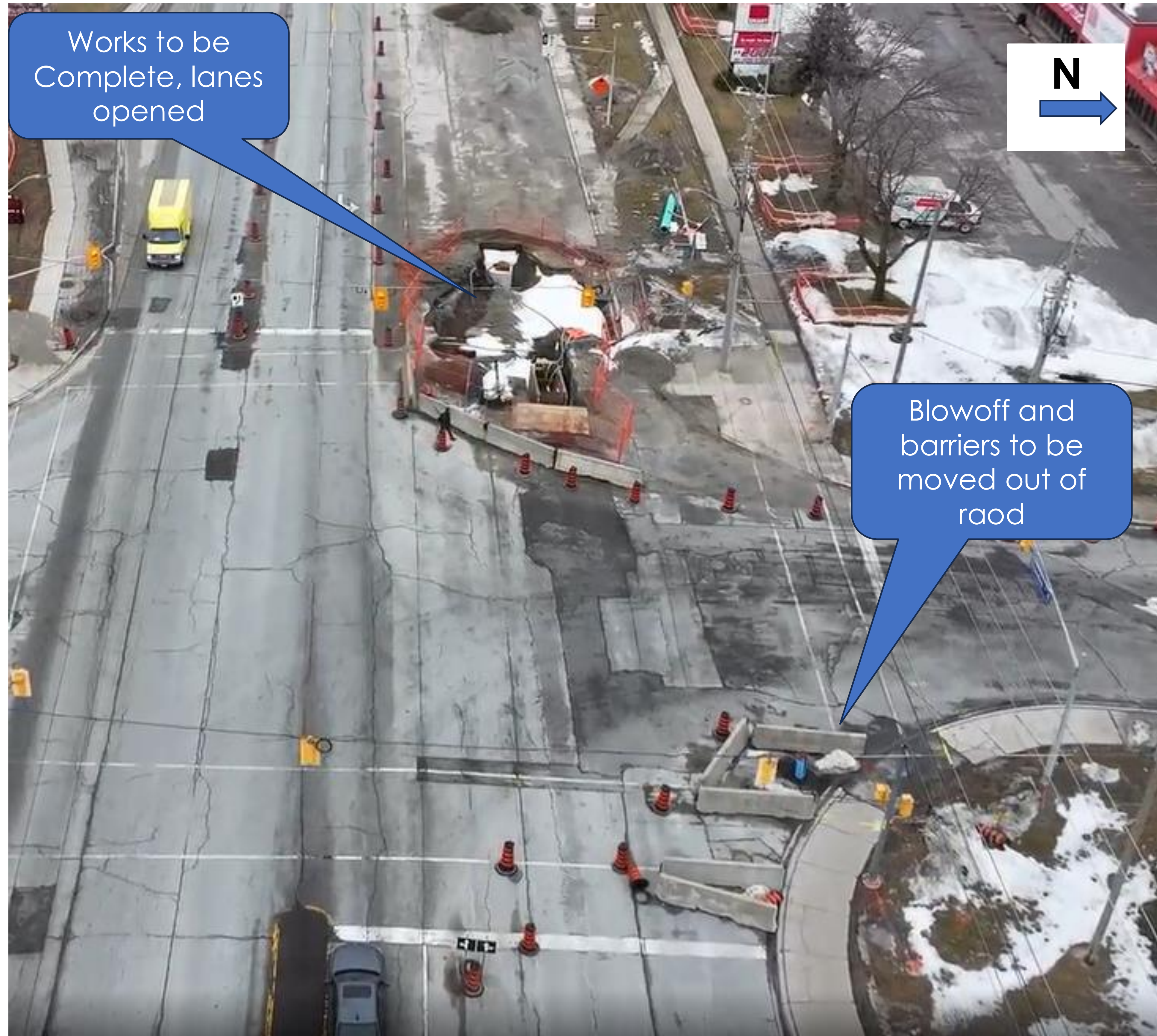

## At Universal Drive – March 7th:

- Complete works at intersection
- Move blowoff and barriers
- Open Westbound lanes From Southcreek Rd to Treadwells Dr

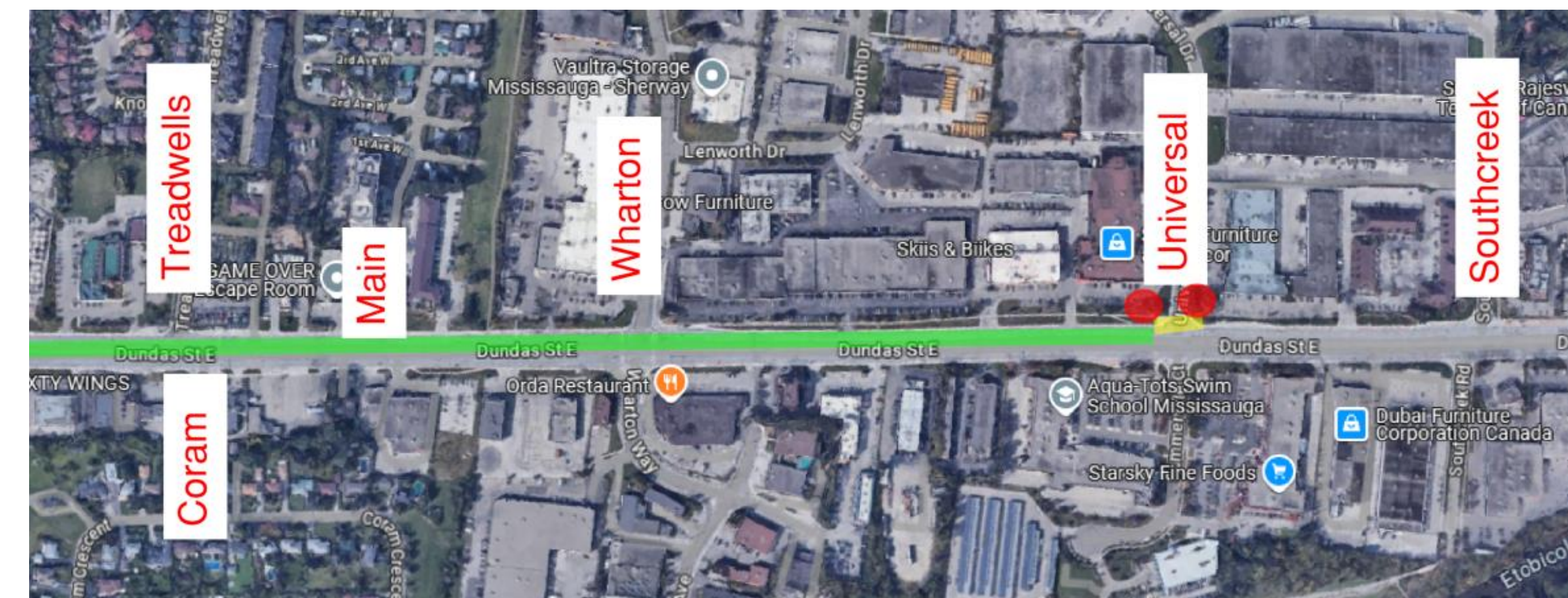

# Immediate Action Items



## At Universal Drive – March 27th:

- In process of completing storm works
- Right turn lane opened back up
- By Wednesday of next week, works will be complete, asphalt restored, lines painted and westbound traffic will be open

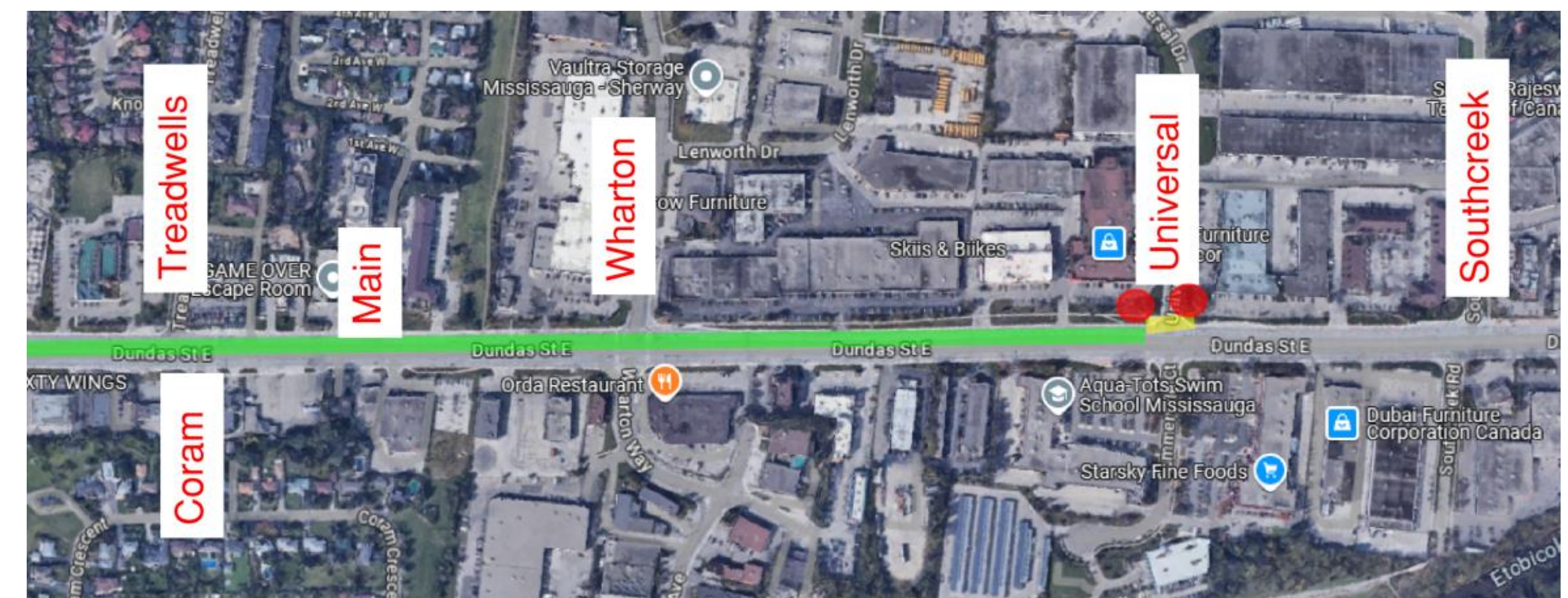

# Long Term Solutions to Traffic Control Issues



Daily Traffic Checks from Peel Inspection

Ensure line painting and footprint are adequate



Include transit representative from Mississauga into weekly staging/traffic controls discussion



Where possible, work with Contractor to establish an extra lane through the project area



Move Unused equipment to their compound



Provide a detailed project update to businesses and residents

# Long Term Solutions to Traffic Control Issues

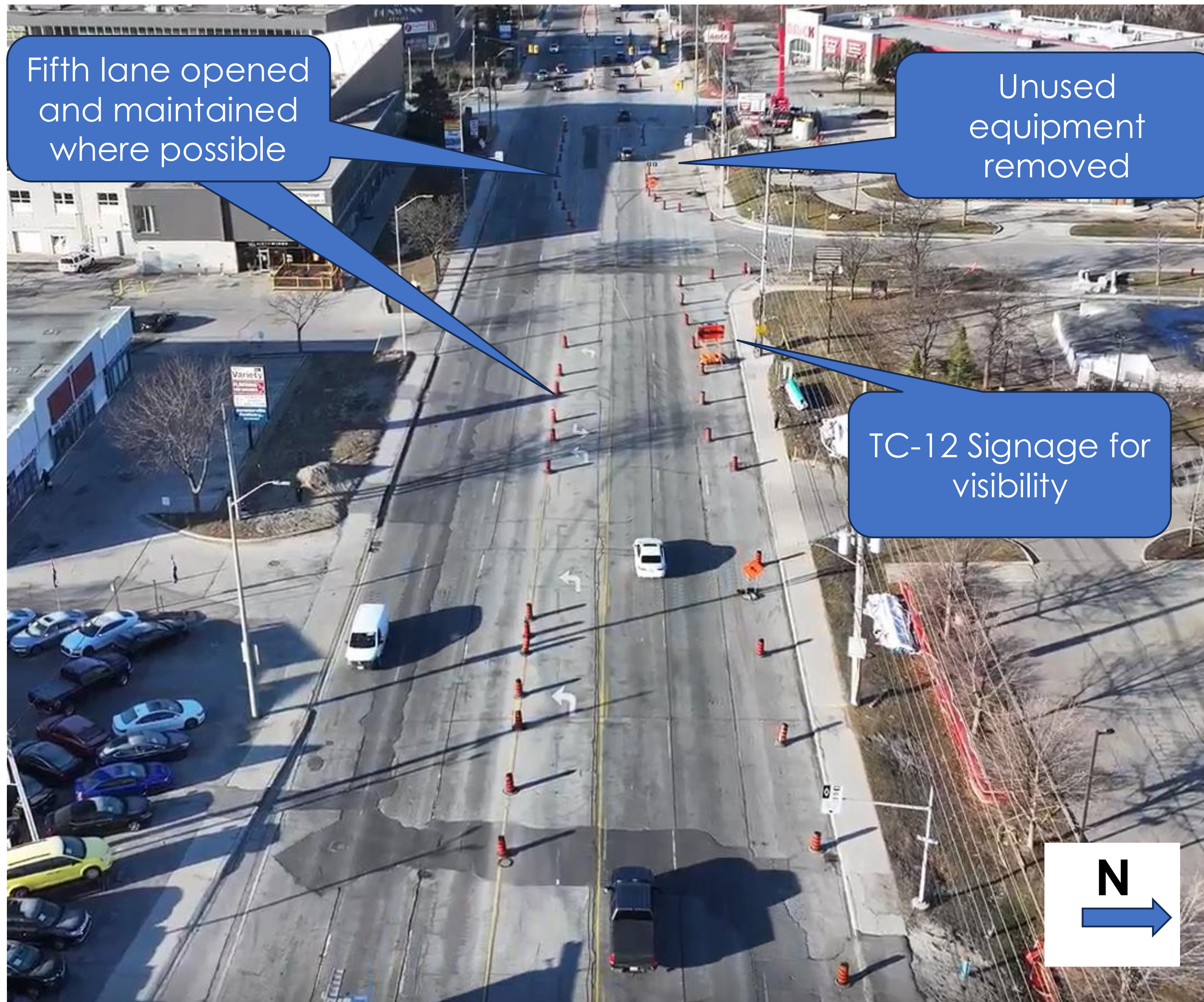

## Improvements due to Long Term Solutions:

- Traffic checks advised the addition of TC-12 (arrow board) signage to help lane reduction visibility
- Opened 5<sup>th</sup> lane where possible to allow left turns without backing up traffic
- Removal of unused equipment

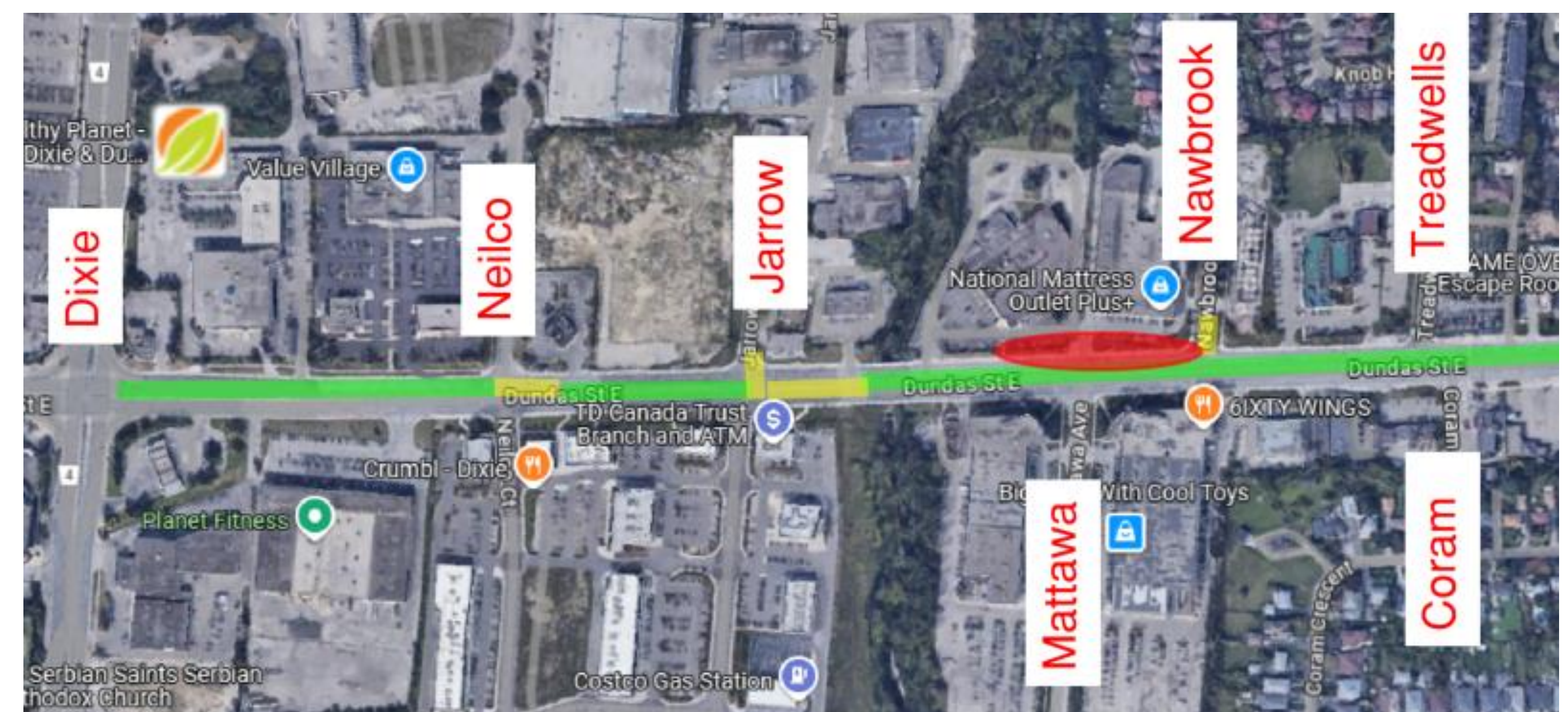

# Current Project Progress



## **To Complete:**

- Remaining Mainline work
- Commissioning
- Connections to Existing Watermain and Service Connections
- Restoration
- End date: July 2025

## **Potential Solutions to Expedite Schedule**

- Working on Saturdays
- Bring in extra labour forces
- Increase construction meeting frequency to weekly

# Current Project Progress

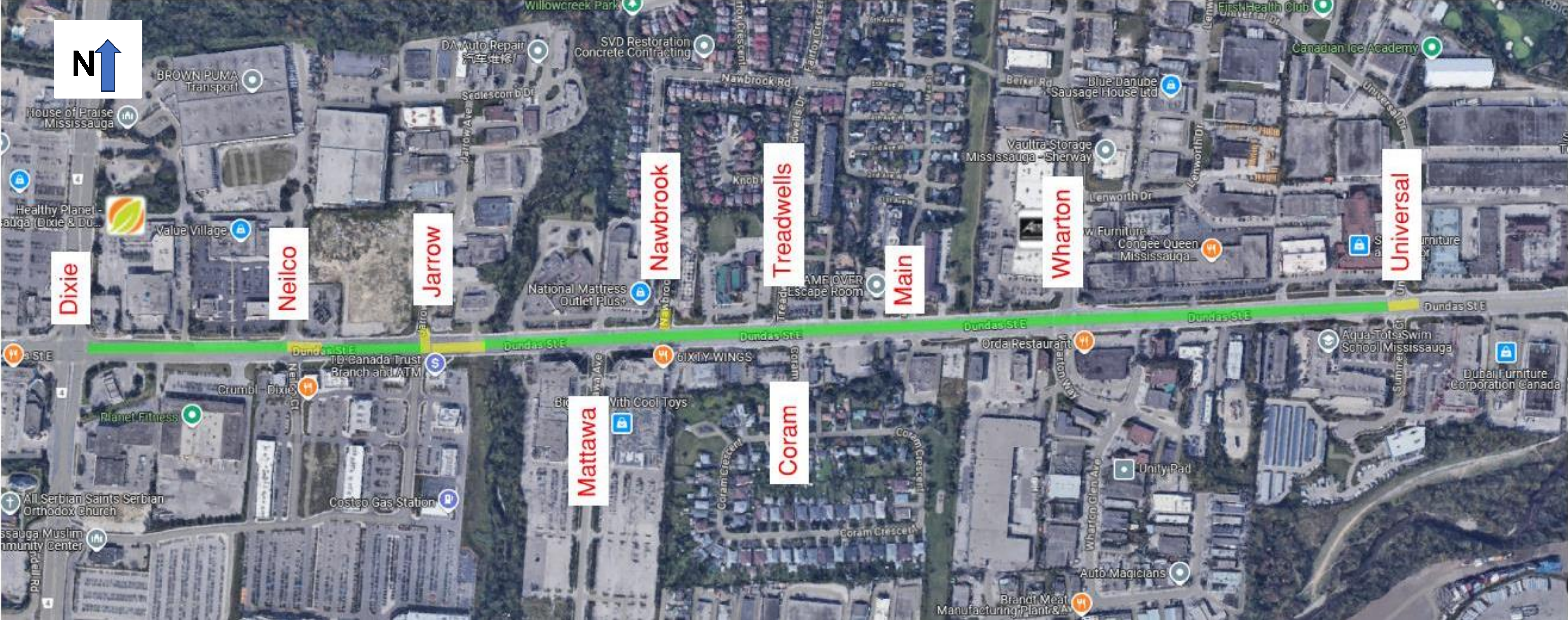

# Current Project Progress

## Mainline Work and Commissioning

- Currently completing the mainline work (yellow)
- Commissioning commences upon completion of mainline

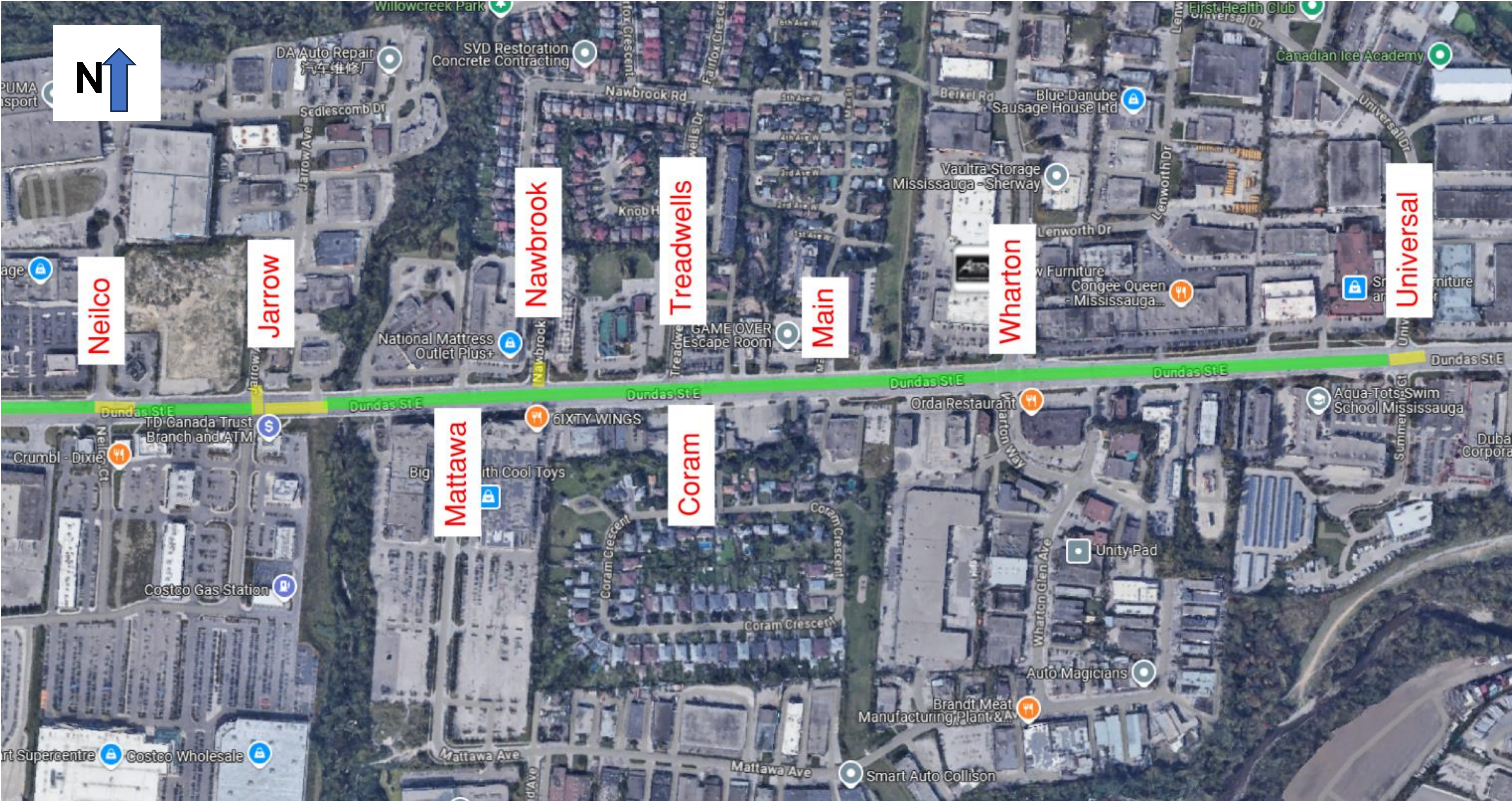

# Current Project Progress

## Connections to Existing System

- Once Commissioned, mainline will be connected to existing watermain system
- Service Connections

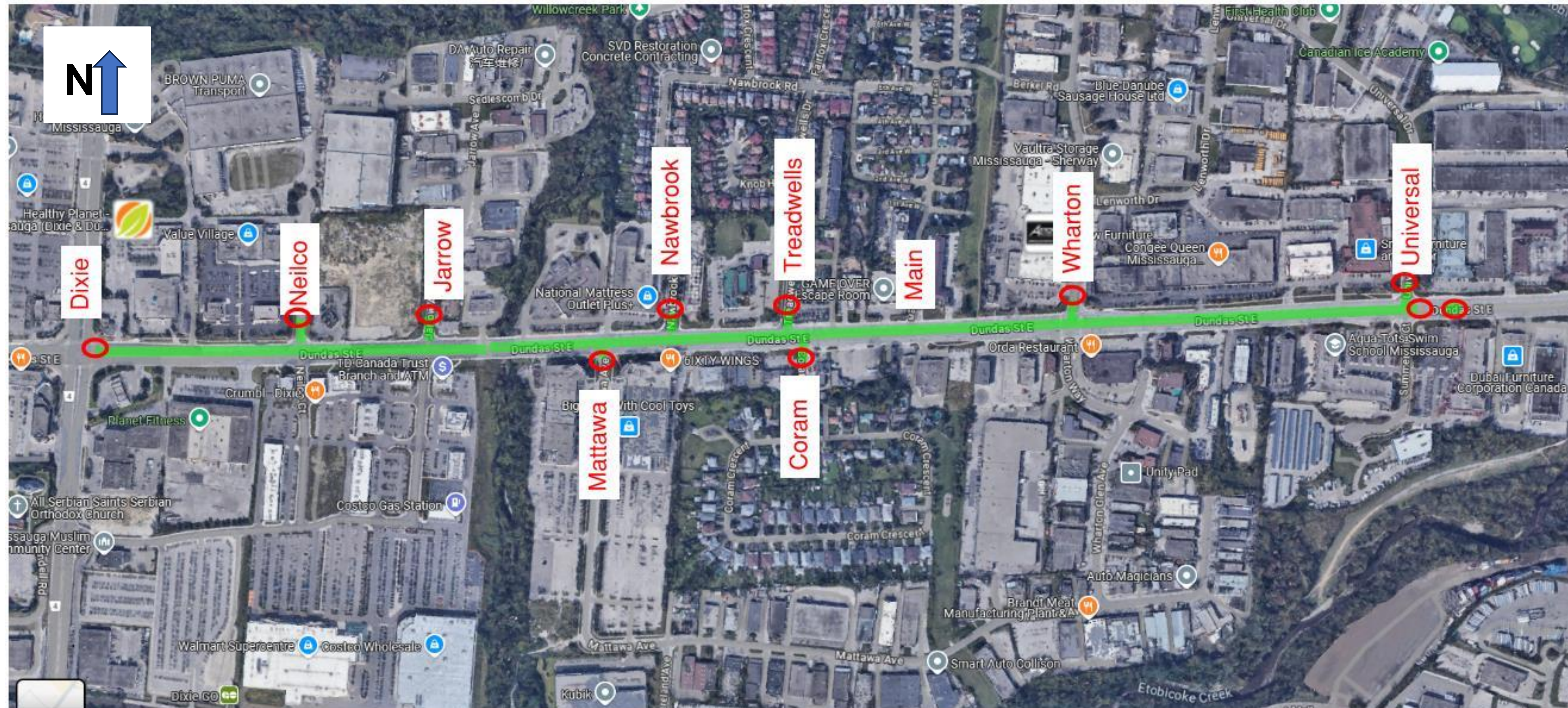

## **Once Connections have been completed, restoration will commence:**

- Replacing Roads, sidewalks, sod
- Requires a sub-contractor and new traffic control plans
- Asphalt plants do not open until May
  - Current asphalt restoration is temporary
- Find ways to minimize traffic impacts
  - Working at night
  - Rolling closures
  - Keeping lanes open during boulevard and sidewalk work