

NEIGHBOURHOOD WATCH



Agenda

1. Introduction to Safe City Mississauga and Neighbourhood Watch Program
2. The Crime Prevention Management System (CPMS)
3. Observe and Report
4. Crime Prevention Education
5. Community Engagement

Organization Overview



300 City Centre Drive, Mississauga, ON, L5B 3C9

Email: nsm@safecitymississauga.on.ca

Web: www.safecitymississauga.on.ca

- Youth Services
- Campaigns
- Data Analysis and Research
- **Neighbourhood Services**

- Formed by the City of Mississauga in 1992
- Tasked with providing Mississauga with crime prevention programs and campaigns
- Programs offered at no-cost, in partnership with Peel Police and City of Mississauga

The Crime Prevention Management System

The Future of Neighbourhood Watch

- Safe City Mississauga had always been considering a move to adapt our programs to the virtual landscape. The pandemic provided that opportunity.
- The Crime Prevention Management System will be accessible to all registered NW members.
- It will be home to an online learning management system, virtual communications hub, access point for future webinars, and more!
- Content will be regularly updated – let us know what you're interested in!

COMMON MISCONCEPTIONS – WHAT NEIGHBOURHOOD WATCH IS NOT

- It is NOT an excuse to SPY on neighbours
 - We want to keep an eye out on our community, but we still want to be considerate of each other
- It is NOT a invitation to be a volunteer police officer
 - Do NOT engage any suspicious or criminal activities that may put anyone in any danger.



WHAT IS NEIGHBOURHOOD WATCH?

COMMUNITY MOBILIZATION, EDUCATION, & ENGAGEMENT

Main pillars: Observing and Reporting, Crime Prevention Education, Community Engagement

- Non-interventionist: promotes reporting as a reaction to crime (Eyes on the Street)
- Encourages personal responsibility and education to implement crime prevention
- Encourages closer social cohesion and collaboration



**PREMISES
PROTECTED BY
NEIGHBOURHOOD
WATCH**

*For more information on the Neighbourhood Watch Program, please contact
Safe City Mississauga
www.safecitymississauga.on.ca*





“The police are the public and the public are the police; the police being only members of the public who are paid to give full time attention to duties which are incumbent on every citizen in the interests of community welfare and existence.”

- Sir Robert Peel

OBSERVE AND REPORT!

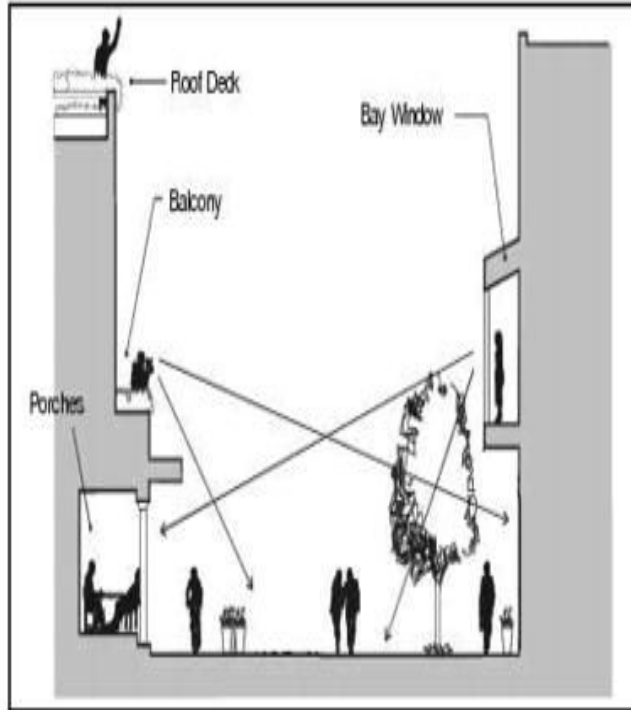

- **“Eyes on the Street”** – Who are the Eyes on the Street? You are!
- Reporting is one of the primary responsibilities of Neighbourhood Watch members.
- The more the community reports, the more police and government will be able to direct attention and resources.

THE IMPORTANCE OF REPORTING

The Dark Figure of Crime

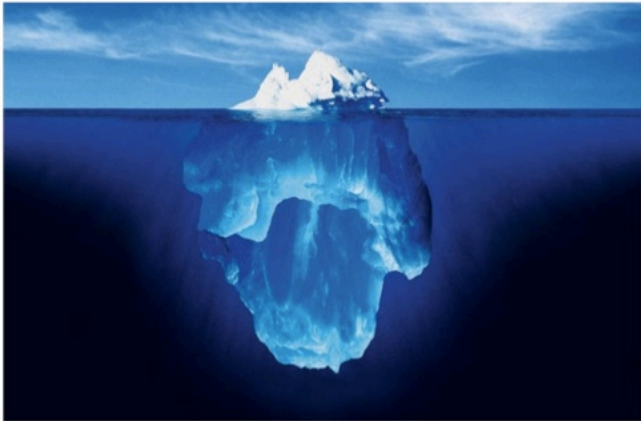

- The 2009 Victimization Survey tells us that only 31% of crimes are reported to the police. Roughly 2/3 of all crime is NEVER reported. This is only observable crime, figures are most likely higher.
- We want to encourage our NWs to report in order to try and account for those 2/3rds of unreported crime.

Reporting Structure



Reporting Structure

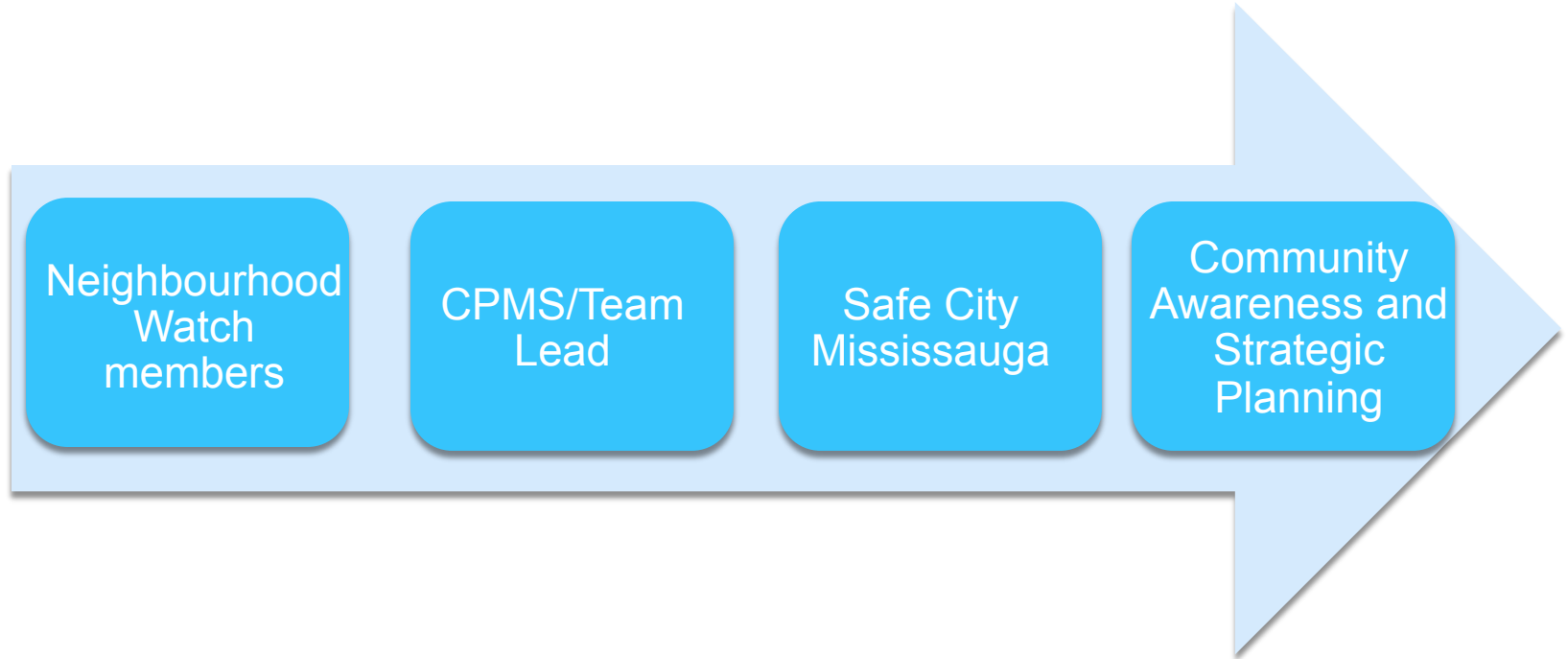

A collective effort!

- ❑ Neighbourhood Watch works best when everyone is working together!
- ❑ Frequent reporting brings awareness to crime issues in the community, which gives neighbours and law enforcement alike more opportunity to prevent further issues.
- ❑ Get to know your fellow neighbours and ensure everyone is actively participating in Neighbourhood Watch. It's never too late to join!



Crime Prevention Education

- The CPMS will be home for all the crime prevention educational material available to Neighbourhood Watch members.
- Current topics available on the CPMS consist of CPTED, The 3 Ds , Common Tricks that Criminals Use.
- Let us know what you're interested in!

ROUTINE ACTIVITY THEORY



Physical convergence in time and space

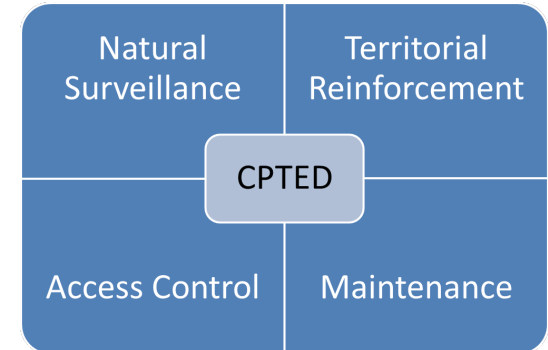

ROUTINE ACTIVITY THEORY

ROUTINE ACTIVITY THEORY

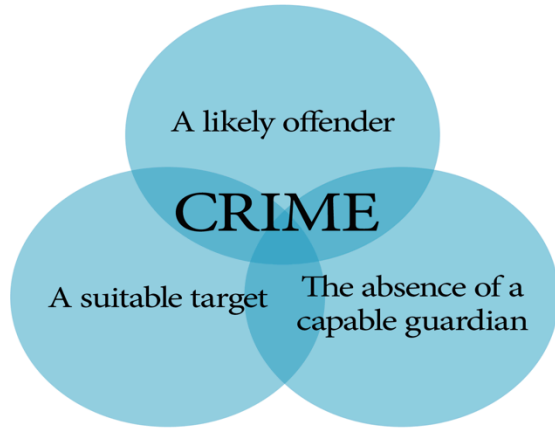

Physical convergence in time and space

- States a crime is most likely to occur when there is a convergence of the three factors
- Assumes criminals are “rational” (meaning they employ cost-benefit analyses to determine the highest rewards for the least amount of risk and effort – just like we all do.)
- May also see “Crime Triangle Theory”
- Both theories argue that crime occurs when the perceived opportunity presents itself (ex. The unlocked vehicle with cash in the cupholder, the person walking home alone at night, the package left at the door all morning, etc.)

Crime Prevention Through Environmental Design (CPTED)

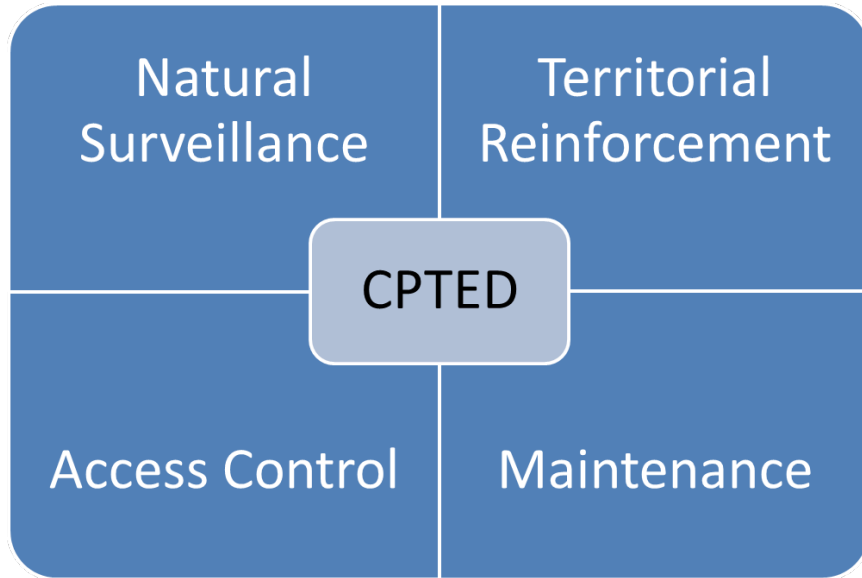

The manipulation of the physical environment to reduce fear and opportunity of crime in a given area.

Proper design, and effective use, improves quality of life.

IMPORTANT: CPTED does NOT PROMISE the full elimination of crime in a given area, but rather the improvement of quality of life and the reduction of the risk and opportunity of crime.

More Crime Prevention Education

- **Routine Activity and CPTED are the core of your crime prevention knowledge. The key = Reduce opportunity for crime, increase risk of criminal failure.**
- Crime Prevention need not be limited to these topics!
- The CPMS will provide access to further in-depth education on these topics
- Educational materials on the CPMS will be regularly refreshed, updated and added to.

Engage the Community

Neighbourhood Watch is a collective effort, but how do we get people to engage with each other and the community? (Consider how this demonstrates ownership of the community BY the community!)

- Operation Clean Sweep
- Neighbours Night Out
- Get creative!
 - Ex. Applewood Road Neighbourhood Watch
 - Charity drives
 - Community Zoom meetings
 - Frontline worker tributes
 - And more...



Crime Prevention must be a regular practice



**PREMISES
PROTECTED BY
NEIGHBOURHOOD
WATCH**

*For more information on the Neighbourhood Watch Program, please contact
Safe City Mississauga
www.safecitymississauga.on.ca*

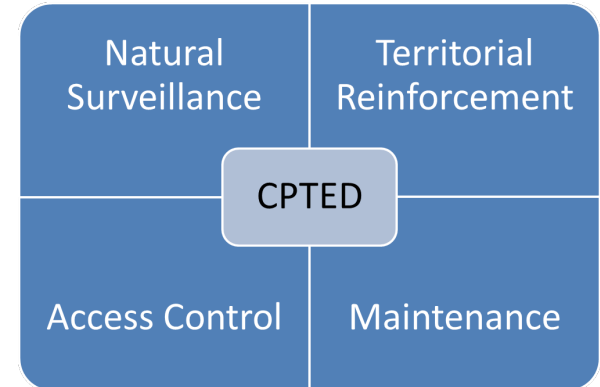

So how do I get started?

- Contact the Neighbourhood Services Team – either through email (nsm@safecitymississauga.on.ca) or on our website (safecitymississauga.on.ca) – to set up a preliminary meeting.
- Determine needs of community and minimum requirements for activation
- Conduct a CPTED analysis
- Host a training meeting
- Order signage
- Register all members to the CPMS
- Neighbourhood Watch activated!

Thank You!

Safe City Mississauga thanks you for your interest in the Neighbourhood Watch program!

Please feel to connect with us on our website or our social media!

www.safecitymississauga.on.ca

Email: NSM@safecitymississauga.on.ca

Twitter: @SafeCityMiss

Instagram: @safecitymississauga

Facebook: Safe City Mississauga